

CASH® Multi Stunner

Spare Parts List



©2019 Frontmatec Accles & Shelvoke Ltd



DO NOT ATTEMPT TO USE THESE STUNNING TOOLS UNTIL
YOU HAVE READ AND UNDERSTOOD THE USER MANUAL

ONLY EVER USE GENUINE ACCLES & SHELVOKE REPLACEMENT PARTS. NOT USING GENUINE PARTS MAY LEAD TO PREMATURE COMPONENT AND TOOL FAILURE, WHICH COULD ENDANGER THE OPERATOR AND THOSE IN THE IMMEDIATE VICINITY. IT WILL ALSO INVALIDATE OUR ORIGINAL EQUIPMENT WARRANTY.

ACCLES & SHELVOKE WILL ACCEPT NO LIABILITY IF ANY COMPONENTS OTHER THAN THOSE SUPPLIED BY ACCLES & SHELVOKE ARE USED WITH OUR ORIGINAL EQUIPMENT. THE RESULTANT LIABILITY WILL BE WITH THE END USER OR THE DISTRIBUTOR WHO SUPPLIED THE UNAPPROVED REPLACEMENT PARTS.

FIG. 11.01

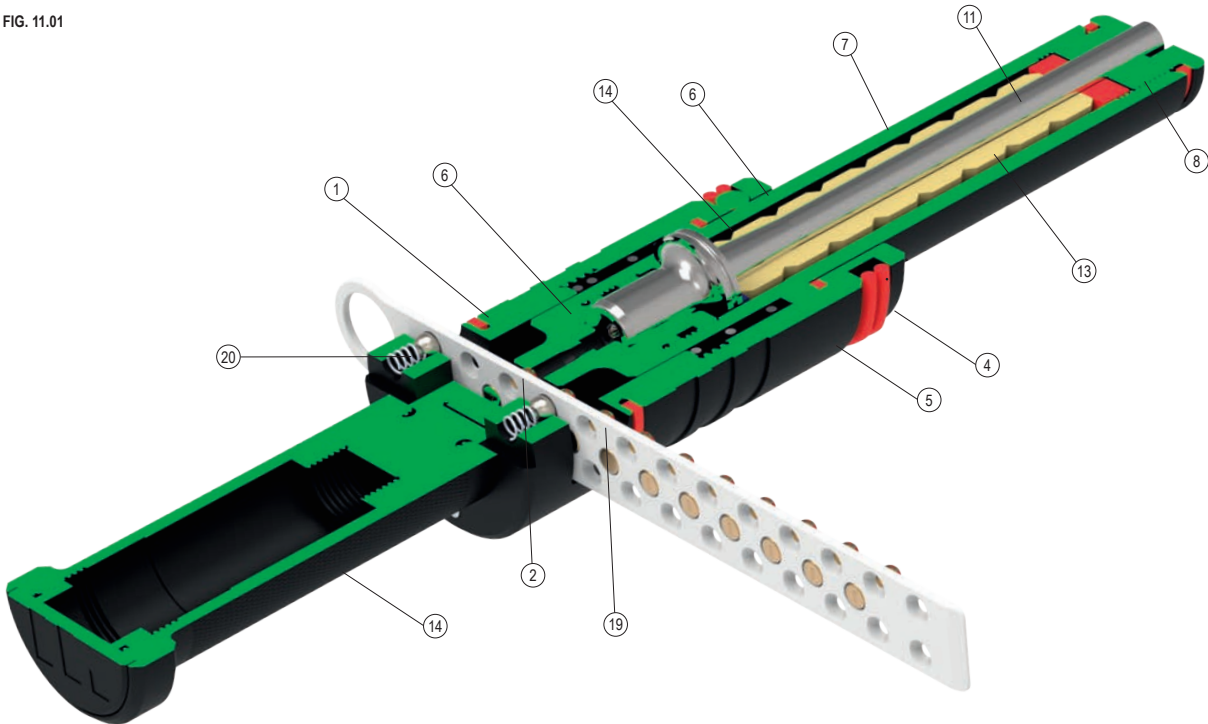

©2019 Frontmate Accles & Shelvoka

Item no.	Part description	Qty per set	SPARE PART BY PRODUCT CODE	IF ORDERING AN ASSEMBLY FOR SPARES, INCLUDES ITEMS LISTED BELOW
			5500	
1	Centre body	1		2, 3, 4, 5
2	Firing pin	1		
3	Phosphor bronze ball	3		
4	O-ring	2		
5	Barrel assembly	1		7, 8, 9
6	Breech	1		
7	Barrel	1		
8	Stop washer	3		
9	Flange washer	1		
10	Lock washer	1		
11	Bolt	1		
12	Muzzle	1		
13	Recuperator sleeves	8		
14	Handle cap assembly	1		17, 18
15	Breech cleaner	1		
16	Undercut cleaner	1		
17	Muzzle spanner	1		
18	Extrator	1		
19	Ratchet ball	4		
20	Ratchet spring	4		

CASH® Multi Stunner

SPARE PARTS LIST AND DIAGRAM

FRONTMATEC

accles & SHELVOKE

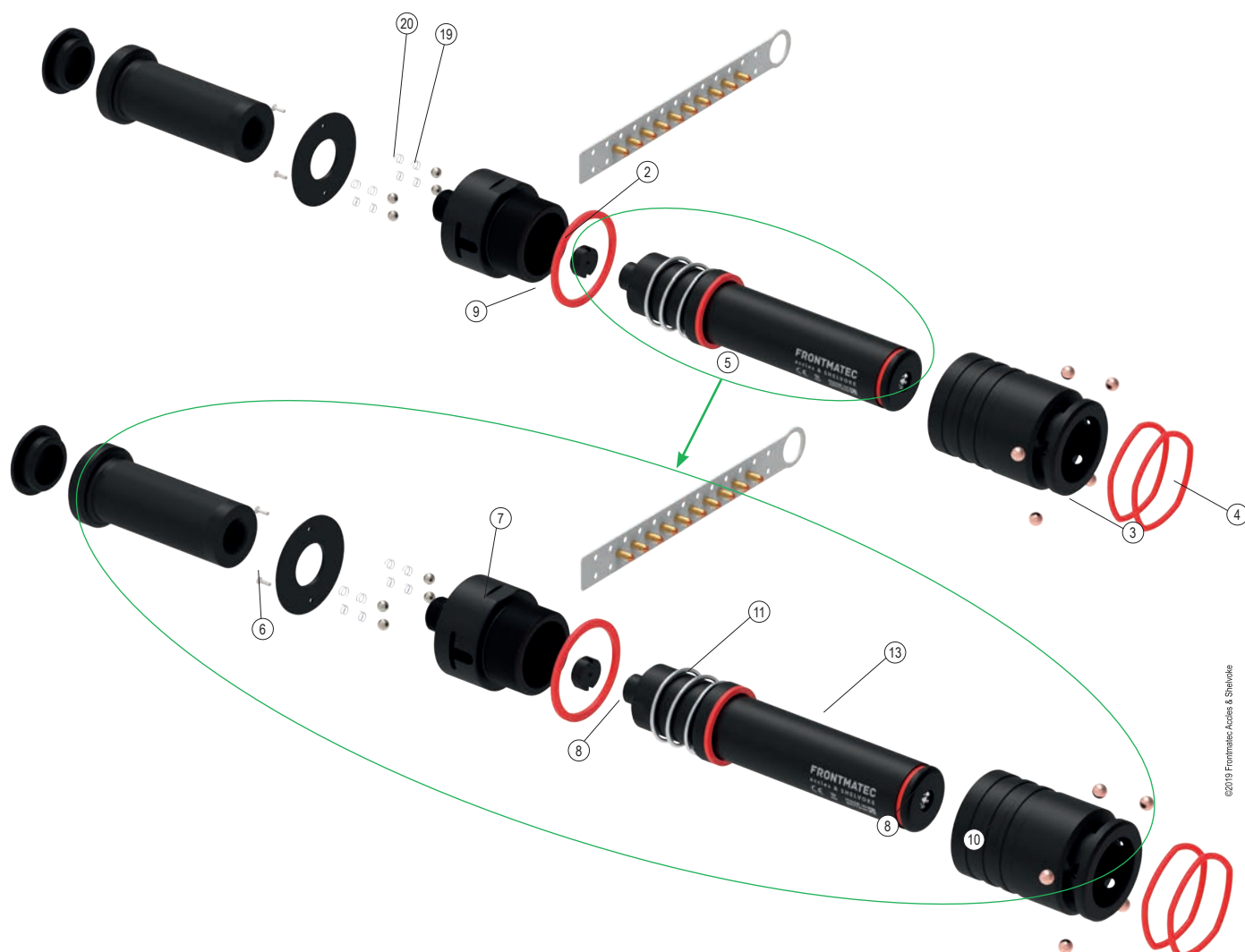

©2019 Frontmatec Accles & Shelvoke

Item no.	Part description	Qty per set	SPARE PART BY PRODUCT CODE	IF ORDERING AN ASSEMBLY FOR SPARES, INCLUDES ITEMS LISTED BELOW
			5500	
1	Centre body	1		2, 3, 4, 5
2	Firing pin	1		
3	Phosphor bronze ball	3		
4	O-ring	2		
5	Barrel assembly	1		7, 8, 9
6	Breech	1		
7	Barrel	1		
8	Stop washer	3		
9	Flange washer	1		
10	Lock washer	1		
11	Bolt	1		
12	Muzzle	1		
13	Recuperator sleeves	8		
14	Handle cap assembly	1		17, 18
15	Breech cleaner	1		
16	Undercut cleaner	1		
17	Muzzle spanner	1		
18	Extrator	1		
19	Ratchet ball	4		
20	Ratchet spring	4		